



GROUND FIRE EXTINGUISHING

1. General

- A. Besides the fire extinguishing systems for engines, APU, lavatories and cargo compartments, the aircraft is equipped with five halonite type portable fire extinguishers that can be used against all classes of fire. One portable fire extinguisher is located in the cockpit and four portable fire extinguishers are located in the passenger cabin.

The extinguisher agent of the portable fire extinguishers is a mixture of 1211/1301 Halon.

- B. To use the fire extinguisher, hold it upright and pull the locking pin to unlock the spraying lever. After this, press the lever for the discharge operation.
- C. During the discharge operation, stand approximately 2 m (8 ft) away from the fire before discharging. Aim the discharge nozzle at the fire base and spray quickly from side to side across the fire width. Move closer as fire is being extinguished and direct all of the discharging agent onto the fire and make sure that the fire is completely extinguished.
- D. After the fire extinguishing, ventilate the area as promptly as possible.
- E. In case of fire in the cargo compartment, if the cargo door is closed and the aircraft is on ground at the time of the smoke warning, ground staff should be informed not to open the affected cargo door unless passengers have disembarked and fire fighters are present. Do not discharge aircraft fire extinguishing agent if smoke warning is displayed on ground and cargo door is open. Ground staff should be required to investigate and extinguish smoke sources.

2. Fire in the Landing Gear Wheelwell and Brakes

WARNING: DO NOT GO NEAR THE WHEEL FROM THE SIDES. IF A TIRE BLOWS UP, THE PARTICLES FROM THE TIRE CAN CAUSE DAMAGE TO THE EQUIPMENT OR INJURY TO YOU.

- A. Approach the wheel from the rear or from the front only as shown in [Figure 1](#).
- B. Extinguish the fire with a jet of Halon 1211, applying the agent with brief intermittent jets, and limiting the quantity to a minimum.
- C. After extinguishing the fire, cool the brake by spraying it with Halon 1211. Apply successive jets during 3 to 5 s, then 15 to 30 s, so as to dissipate vapor concentrations.
- D. After cooling the brake, allow a minimum of 15 min to elapse before moving the aircraft.

3. Fire in the Engines

- A. Two fire extinguishing bottles are installed in the wing-to-fuselage fairing. They are designed to operate with Halon 1301 fire extinguishing agent and overpressurized with Nitrogen gas. Controls of the engine fire extinguishing discharges are provided through individual fire handles located on the overhead panel in the cockpit.
- B. If the fire cannot be extinguished from the cockpit by the pilots or by a skilled technician, start extinguishing the fire as shown in [Figure 2](#) using Halon 1211 extinguishing agent.

4. Fire in the Tail Cone

- A. One APU fire extinguishing bottle is installed outside the APU compartment in the rear fuselage. It is designed to operate with Halon fire extinguishing agent and overpressurized with Nitrogen gas.



Control of the APU fire extinguishing discharge is provided through the APU fire extinguishing switch, which is guarded against unintended operation and located in cockpit.

- B. If the fire cannot be extinguished from the cockpit by the pilots or a skilled technician, start extinguishing the fire as shown in [Figure 3](#) using Halon 1211 extinguishing agent.



EFFECTIVITY: ALL

Fire in the Landing Gear Wheelwell and Brakes

Figure 1

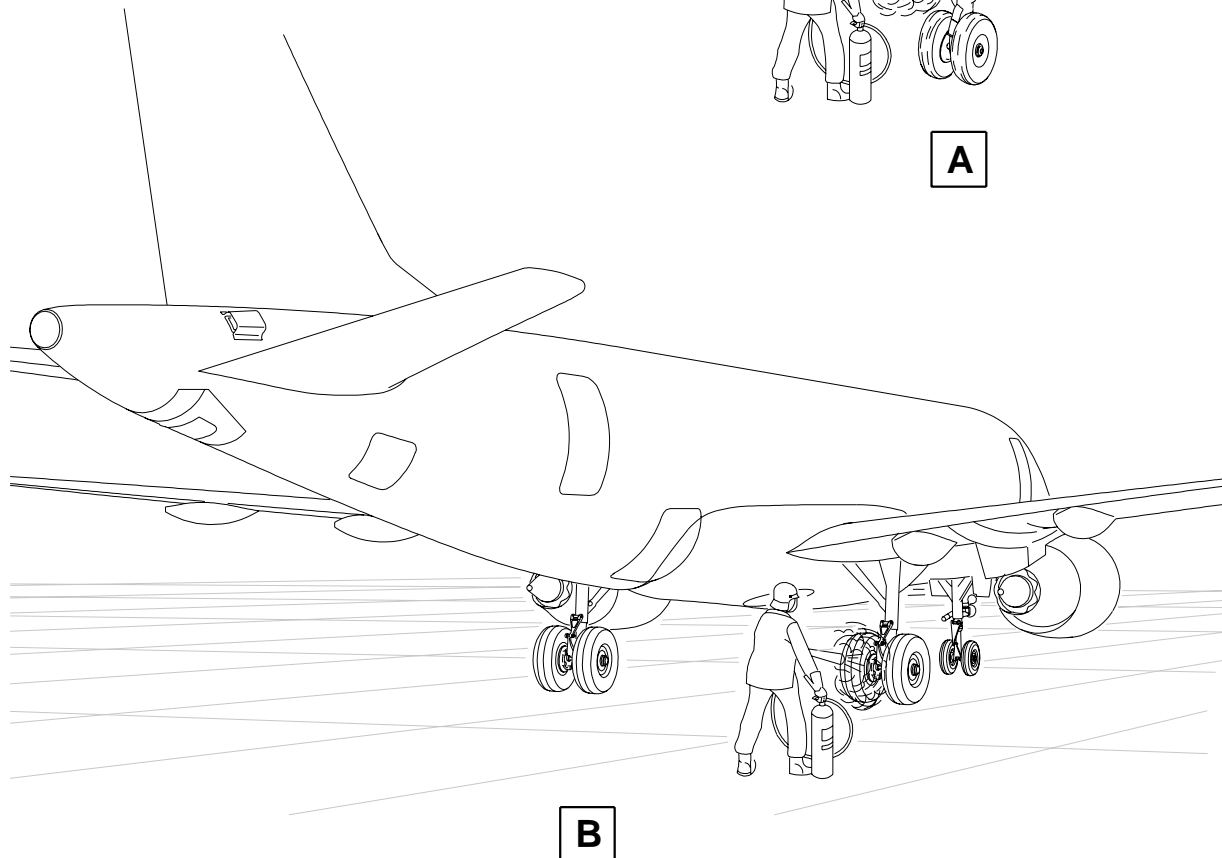
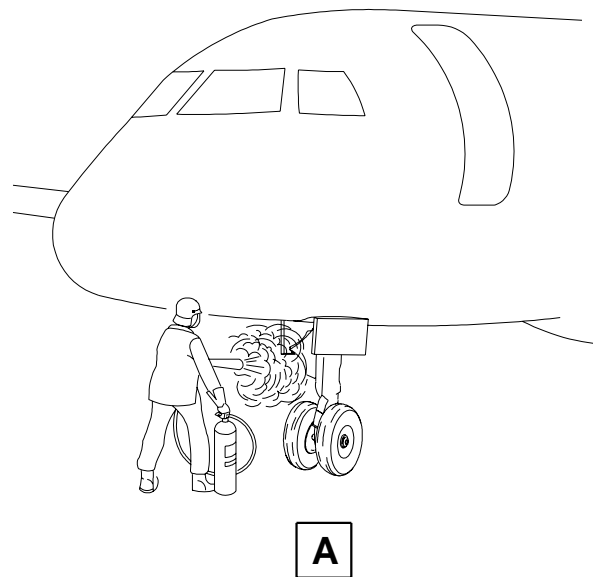
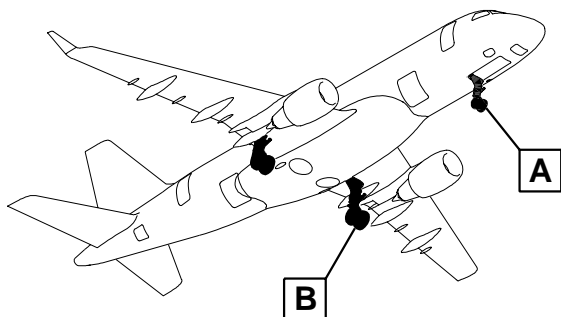

NOTA:
APPROACH THE WHEEL FROM THE REAR OR FROM THE FRONT ONLY.



EFFECTIVITY: ALL
Fire in the Engines
Figure 2

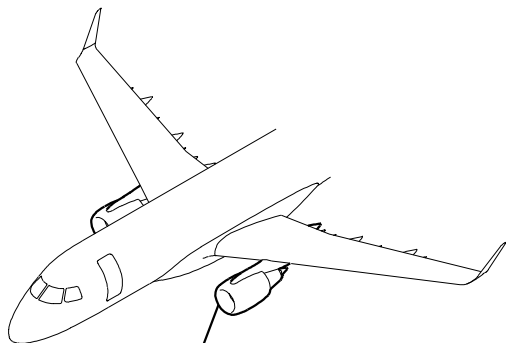

A

ZONES
410
420

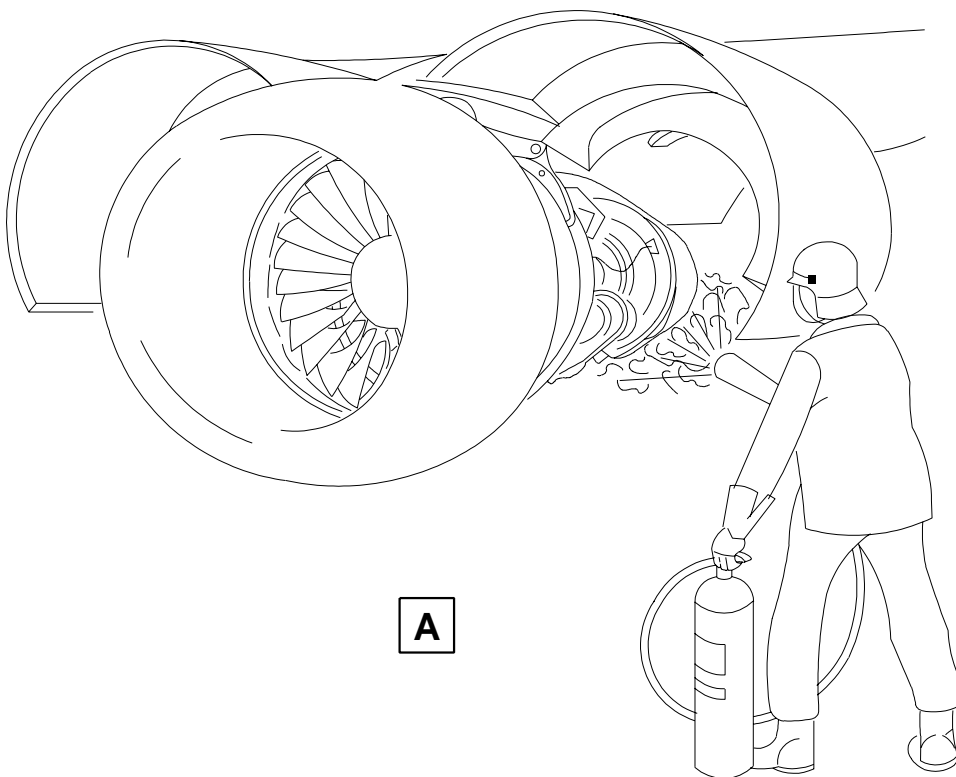

A

IF170IGFER060002.DGN



EFFECTIVITY: ALL
Fire in the Tail Cone
Figure 3

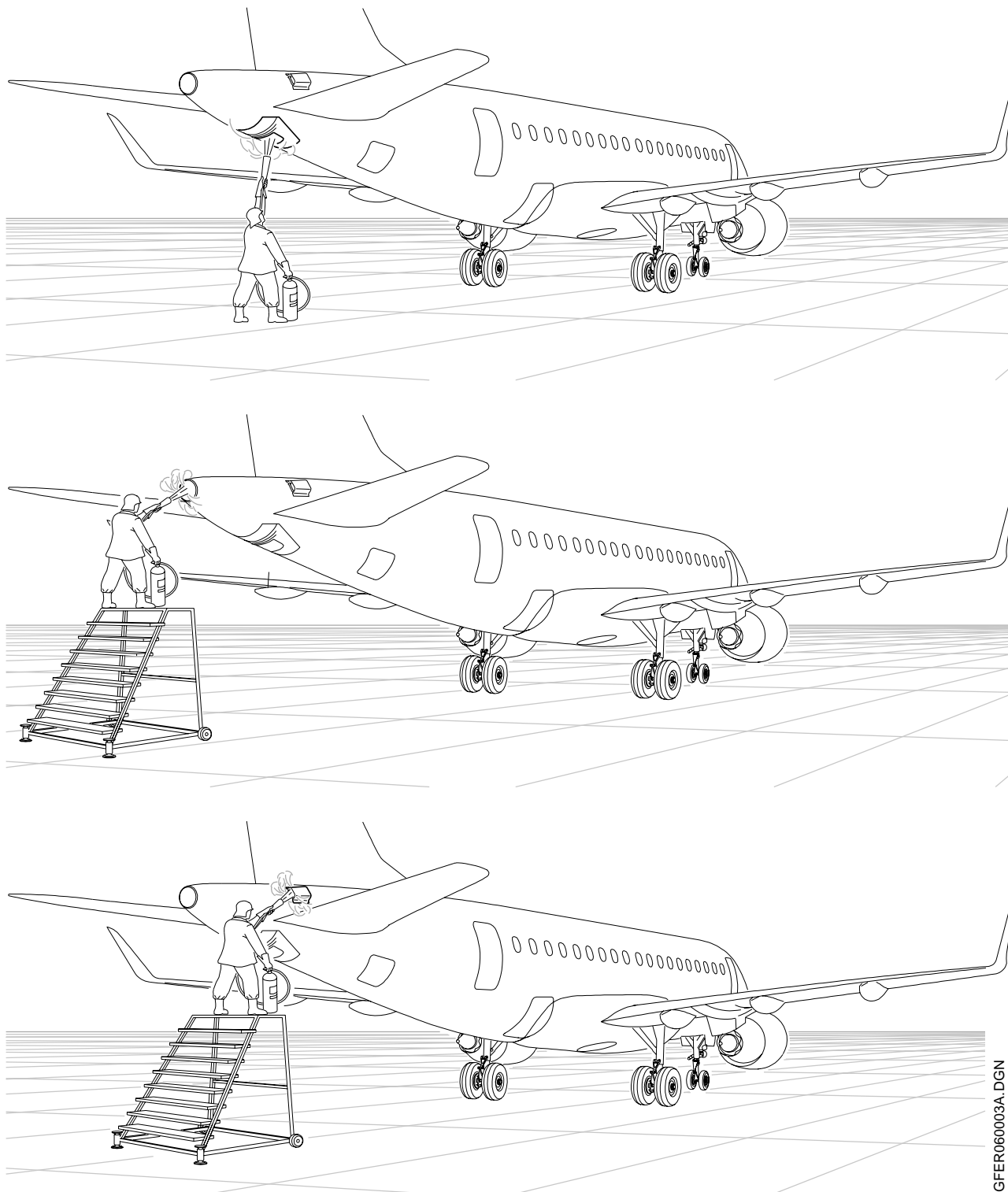

IF170IGFER060003A.DGN



AIRCRAFT RESCUE & FIREFIGHTING INFORMATION

1. General

A. This section gives the information to the Aircraft Rescue and Firefighting Crew.



**EMBRAER 170
175**

**INSTRUCTIONS FOR GROUND FIRE
EXTINGUISHING AND RESCUE**

EFFECTIVITY: ALL
Aircraft Rescue & Firefighting Information
Figure 1

AIRCRAFT RESCUE & FIREFIGHTING INFORMATION

EMBRAER 170	EMBRAER 175
FLIGHT CREW: 2 CARGO: 3 PASSENGER: 70 - 78	FLIGHT CREW: 2 CARGO: 3 PASSENGER: 76 - 86
HEIGHT: 9.82 m WINGSPAN: 28.06 m LENGTH: 31.68 m	HEIGHT: 9.82 m WINGSPAN: 28.06 m LENGTH: 31.68 m
WING FUEL TANKS CAPACITY: 9486 kg (20855 lb)	WING FUEL TANKS CAPACITY: 9486 kg (20855 lb)
FUEL TYPE: - ASTM D1665 - JET A AND JET A1 - ANP 12903 - OAV-1 - MIL-155133 - JP-8	FUEL TYPE: - ASTM D1665 - JET A AND JET A1 - ANP 12903 - OAV-1 - MIL-155133 - JP-8

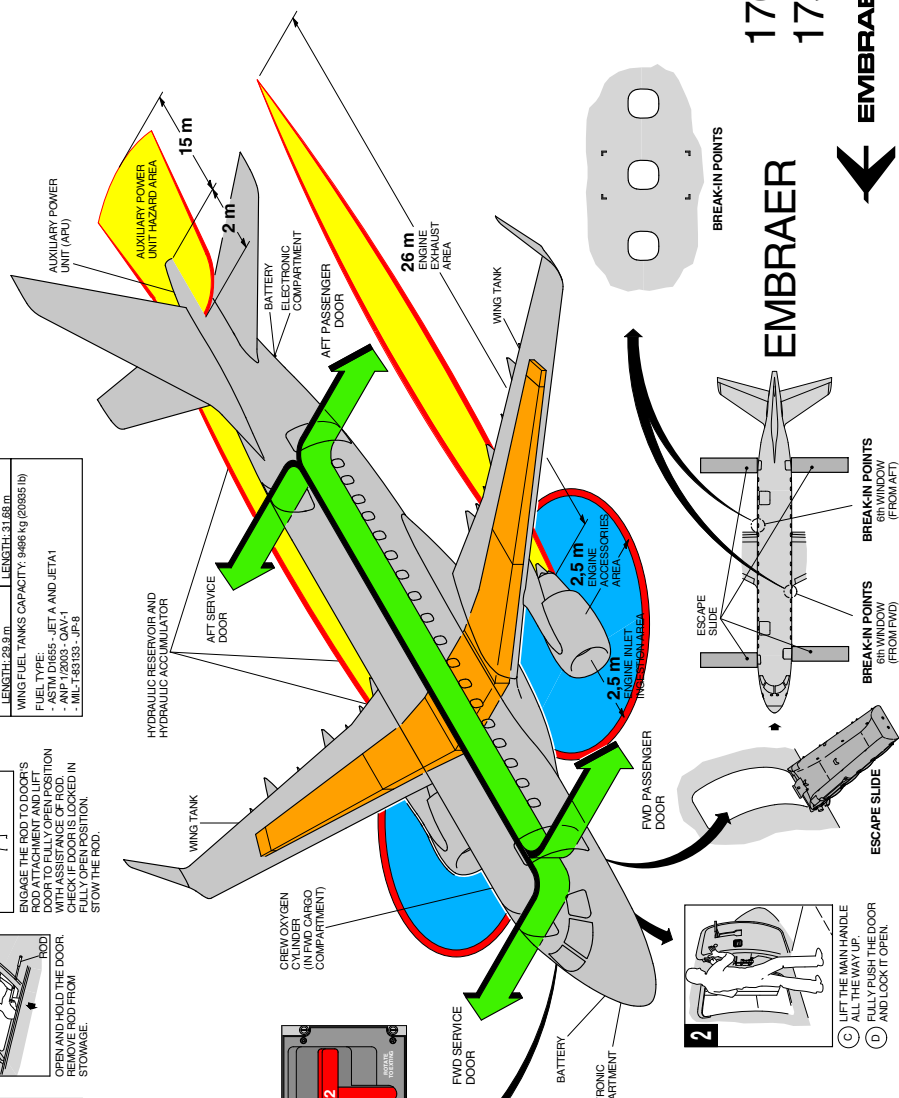
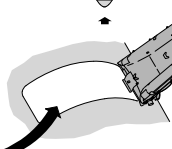
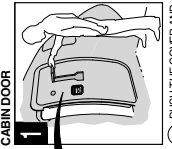
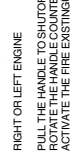
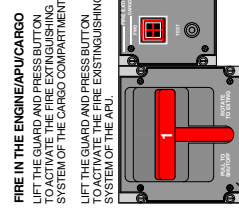
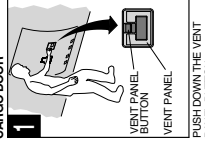
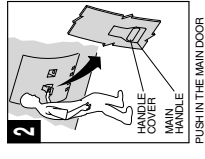
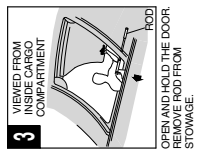
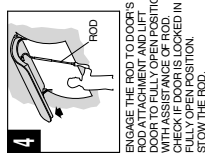

**170
175**
EMBRAER

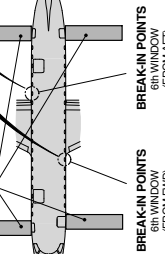

EM170IGFER00007E.IDR